

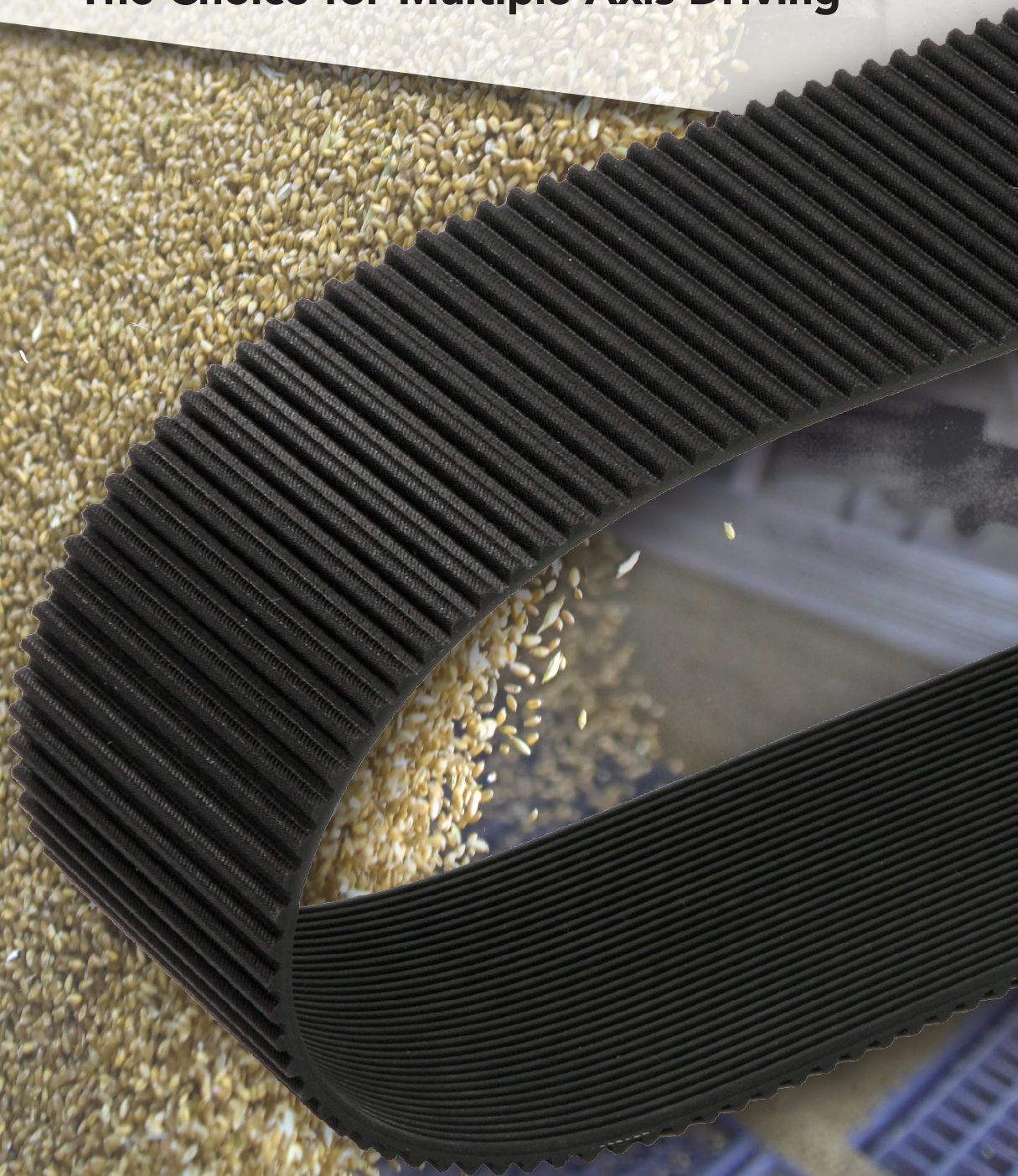

BANDO

TOOTHED RIB BELT

The Choice for Multiple Axis Driving



Application (Grain milling machine)

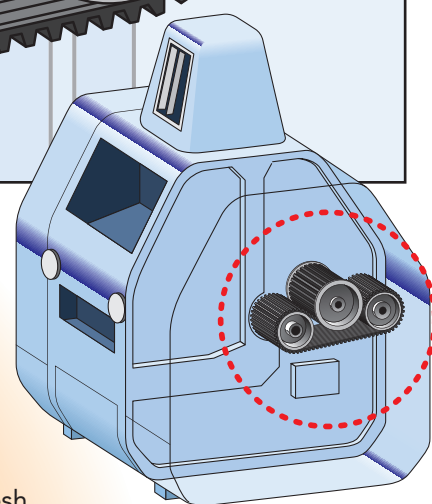
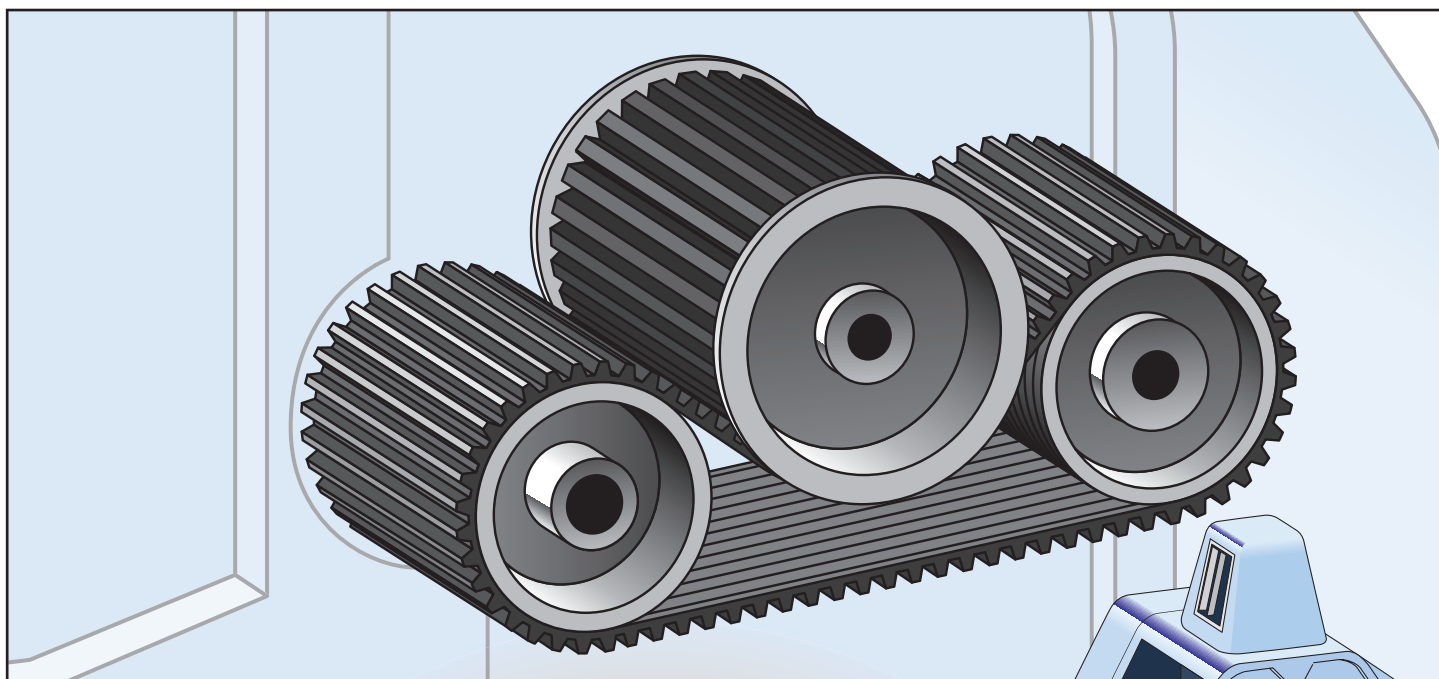

1. Rubber

Chloroprene rubber with excellent durability and wear resistance provides high torque power transmission.

2. Tension Member

Fiber glass cord provides good dimensional stability and flexibility.

3. Tooth fabric

Woven canvas cover provides smooth mesh with the pulley for less friction and lower noise.

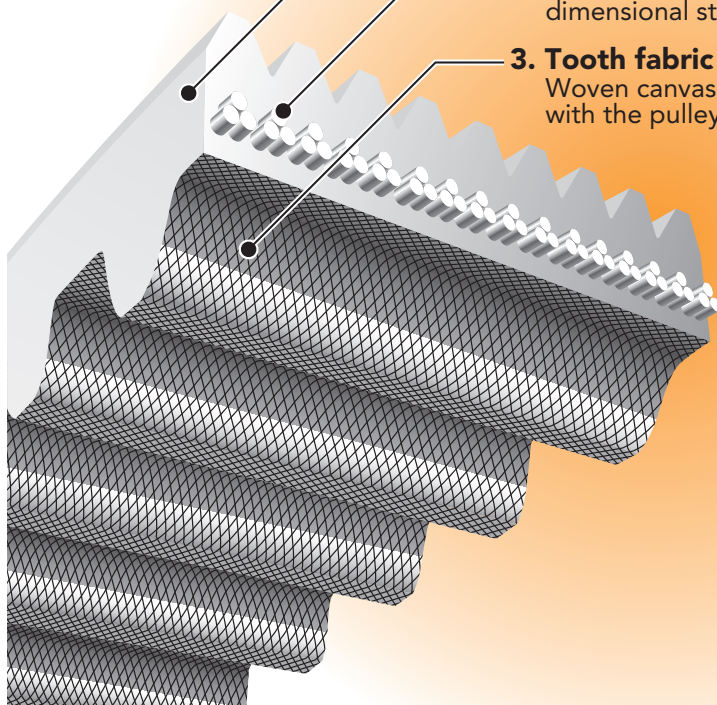

• Example

30PK

No. of Ribs
 $30 \times 3.56 =$
106.8mm width

S8M

Tooth profile
8mm pitch

1552

Belt pitch length
1552mm

• Standard size

PK S8M1552

PK S8M1760

- ✳ Rib Number on request.
- ✳ Multiple matched sets available.
- ✳ Other sizes on request.

BANDO